

RECORD OF HAVING RE-ESTABLISHED A CADASTRAL BOUNDARY

Surveying (Cadastral Surveys) Regulations 2015 - Schedule 4, Regulations 16

LOCATION OF LAND

PROPERTY ADDRESS: 53 MARBLE DRIVE, MELTON SOUTH, VICTORIA, 3338

PARISH: KOROROIT

TOWNSHIP: -

SECTION: C

CROWN ALLOTMENT: 10&11(PARTS)

CROWN PORTION: -

LAST PLAN REFERENCE: LOT 518 ON PS701076H

TITLE REFERENCE: Vol.11580 Fol.491

NOTATIONS

Datum (including previous survey references):

A-B-C-D vide PS701076H

Note that title is to scale and occupation, radiations and marks are exaggerated for diagrammatic purposes.

MGA94 Co-ordinates:

E: 287 402

N: 5 823 309

Zone 55

EASEMENT DETAILS:

E-1: SEWERAGE EASEMENT

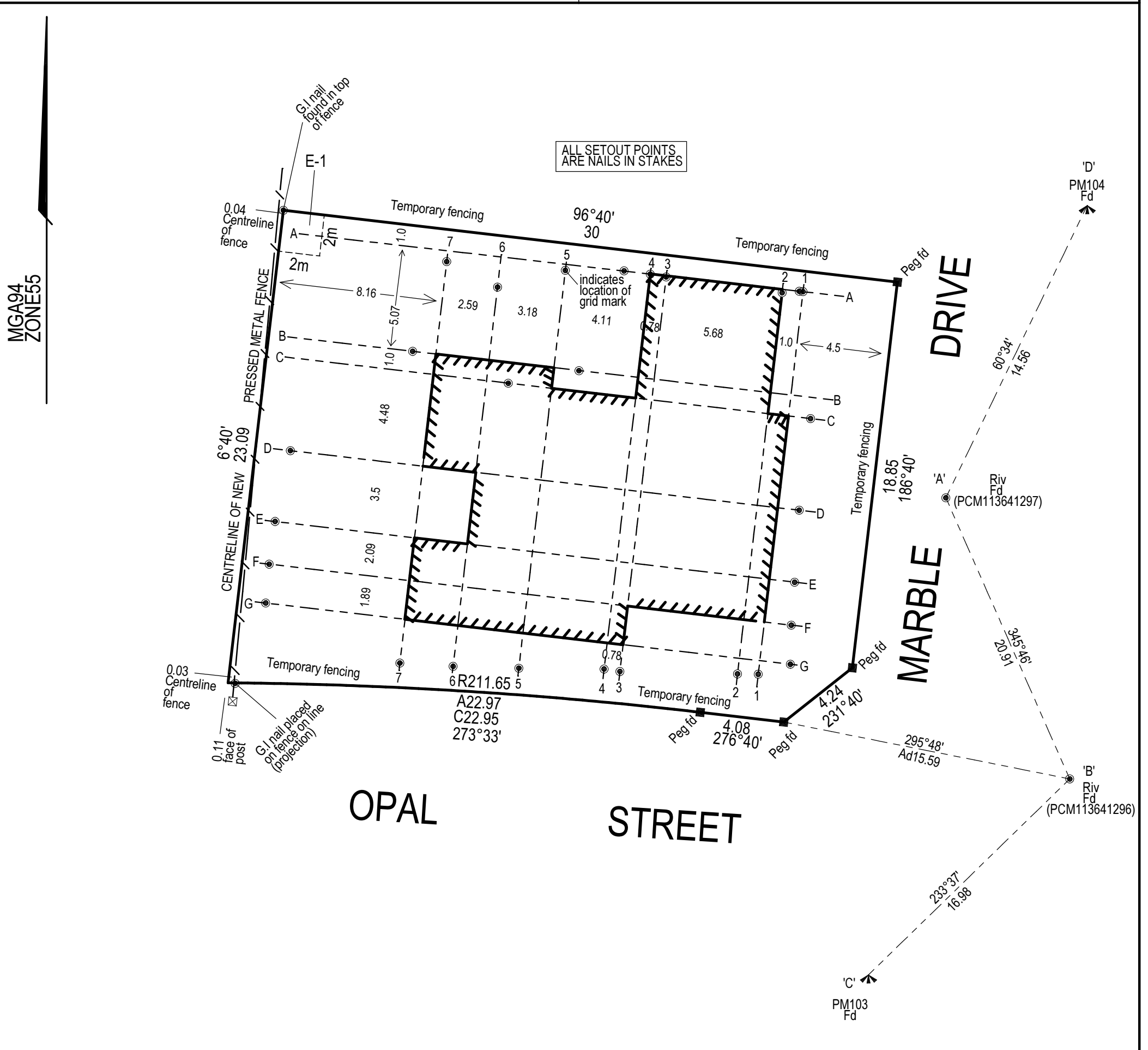

ORIGINAL SHEET SIZE: A3

CERTIFICATION BY SURVEYOR

SHEET 1 OF 1

SCALE
1:200

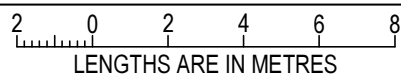

SURVEYORS FILE REF: 2409

I, Benjamin Charles Couch of 10A Waverley Avenue, Ivanhoe, VIC, 3079 certify that this plan has been prepared from a survey made under my direction and supervision in accordance with the Surveying Act 2004 and completed on 18/01/2017, that this plan is accurate and correctly represents the adopted boundaries and the survey accuracy accords with that required for level land as defined in regulation 7(2) of the Surveying (Cadastral Surveys) Regulations 2015



BENJAMIN C COUCH / VERSION No.01